

Q-BA-MAZE™ 2.0 STUNTS

The Next Generation Marble Maze

Instructions: Bounce and Zoom Course

Ages: 6 and up



Important Note!

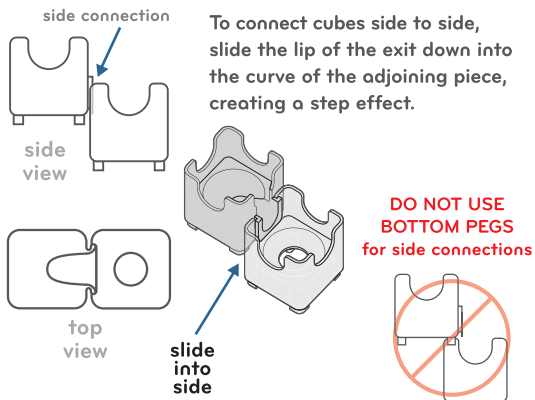

Getting Started

Each color has 3 kinds of cubes

■ single-exit

top view

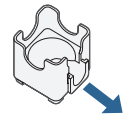

■ double-exit

top view

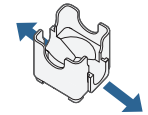

■ bottom-exit

top view



3 kinds of stunts

■ coaster tube

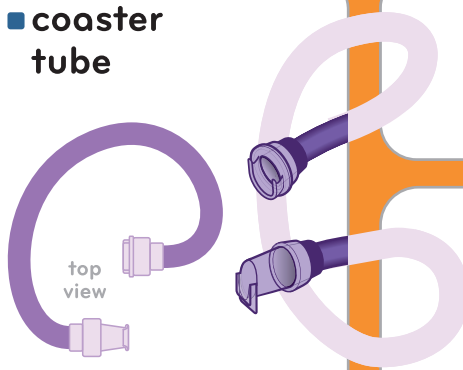

■ pivot trampoline

top view

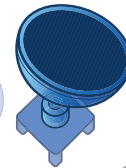

■ roto catcher

top view

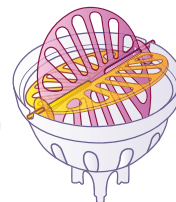

4 marble catchers

■ marble catcher

top view

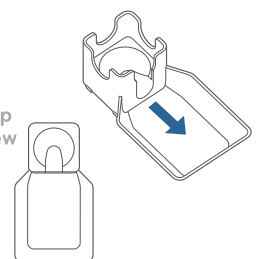

1

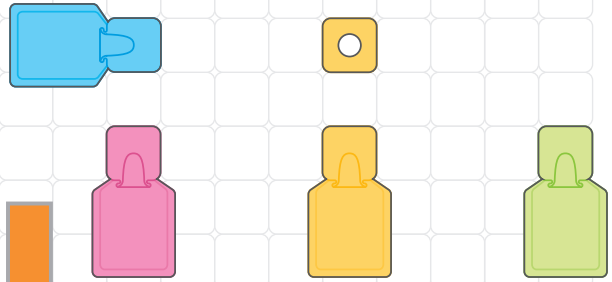

4

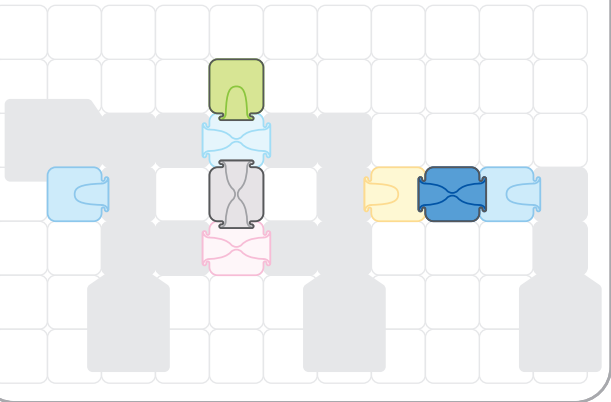
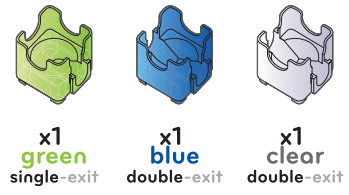

2

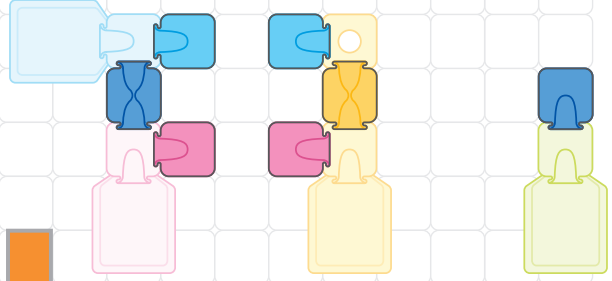
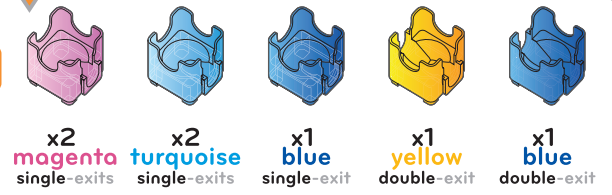

5

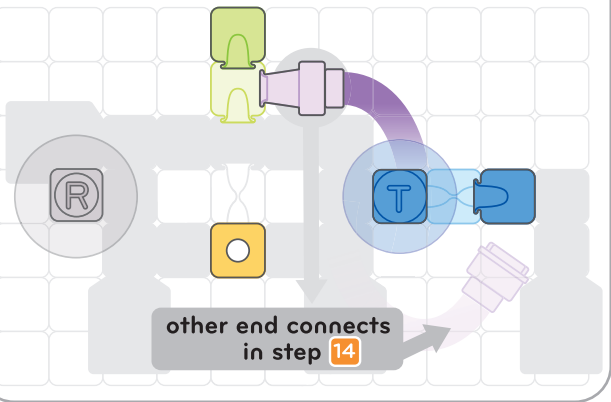
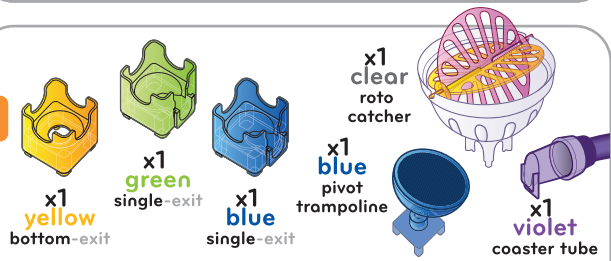

3

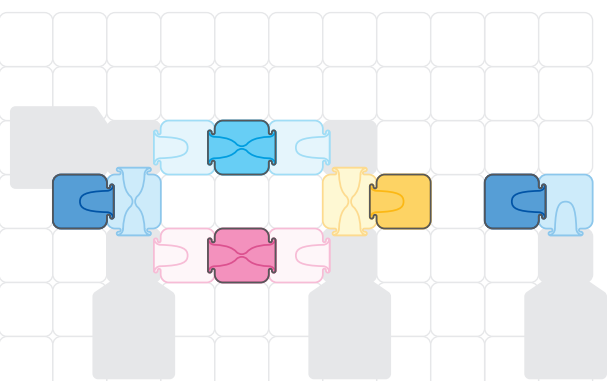

6

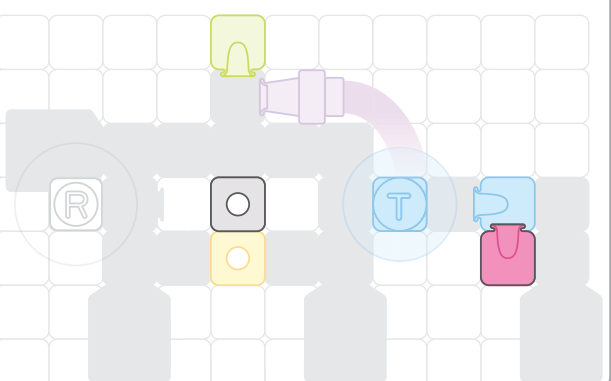
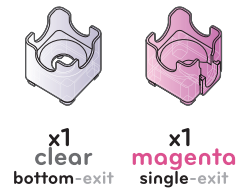

7

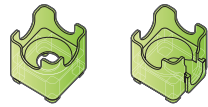

x1 green bottom-exit x1 green single-exit

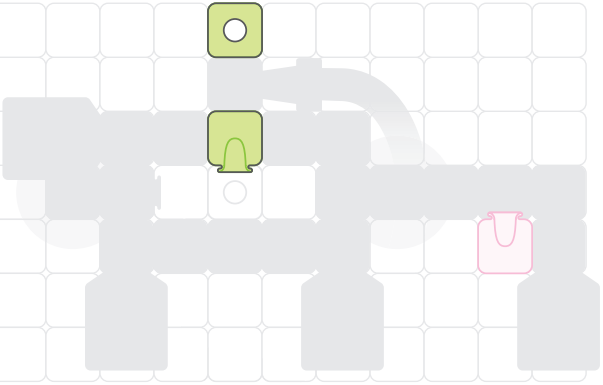

10

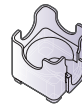

x1 clear single-exit

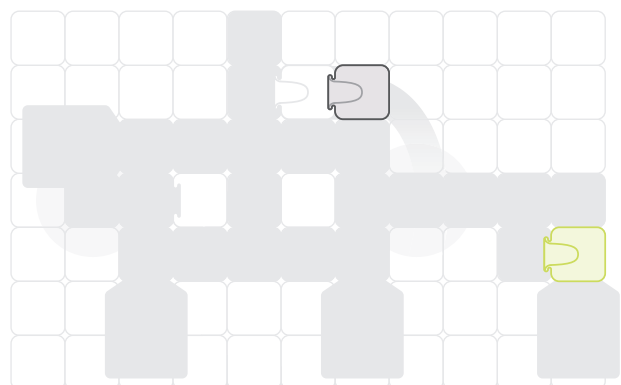

8



x1 green double-exit x1 magenta bottom-exit

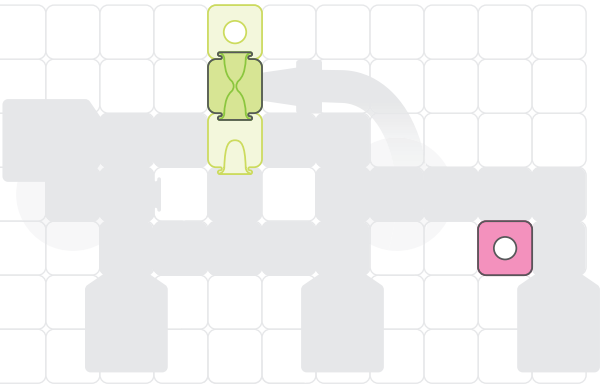

11



x1 yellow single-exit x1 green bottom-exit

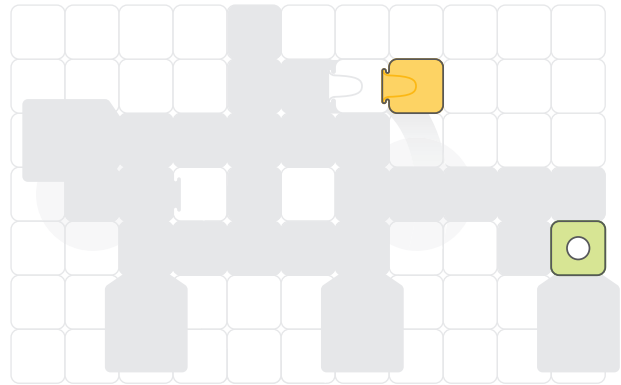

9

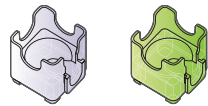

x1 clear single-exit x1 green single-exit

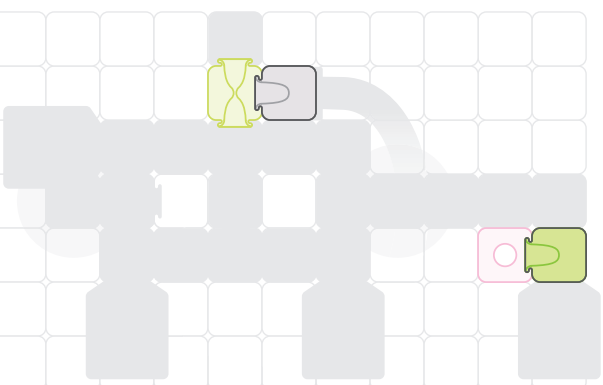

12



x1 yellow single-exit x1 turquoise single-exit

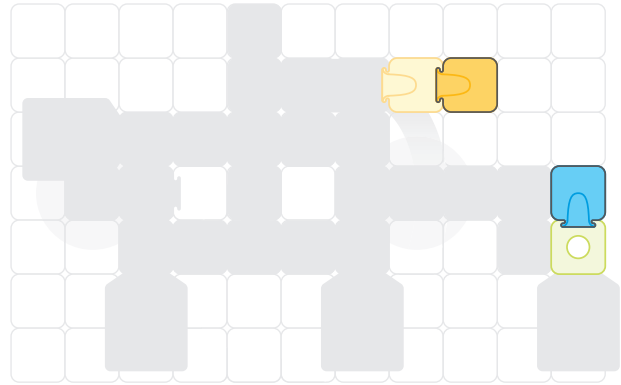

13



x1
yellow
single-exit

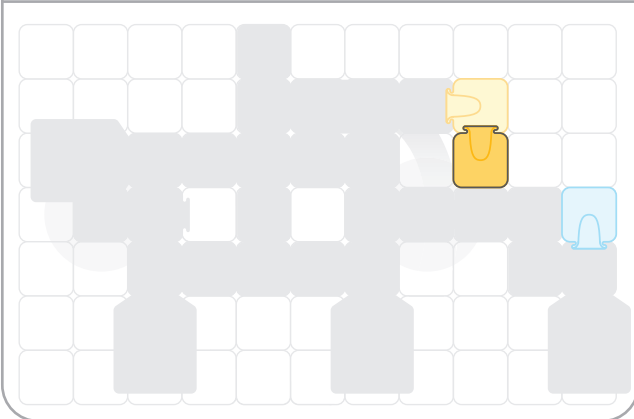

16



x1
magenta
double-exit

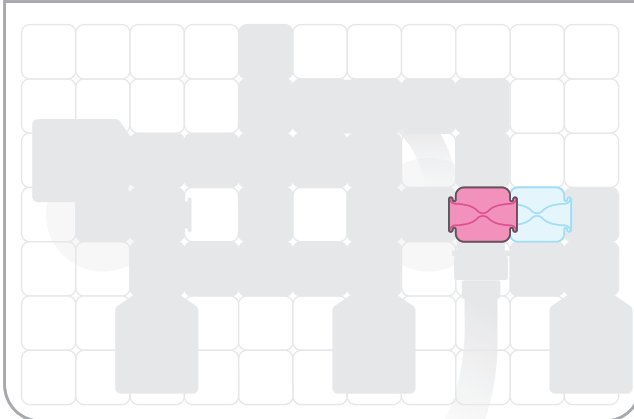

14



x1
yellow
double-exit



x1
turquoise
bottom-exit



x1
violet
coaster tube

tube connected at step 5
use disconnected end

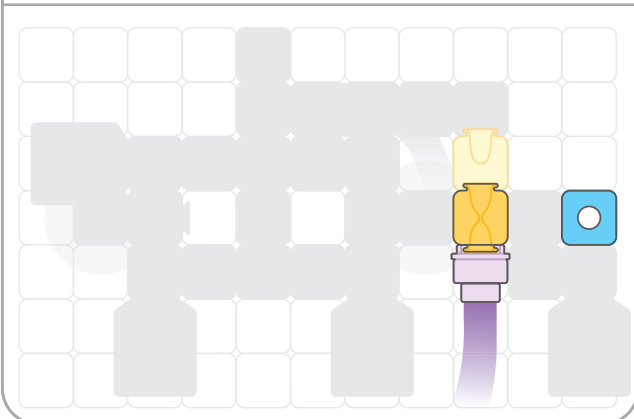

17



x1
magenta
bottom-exit

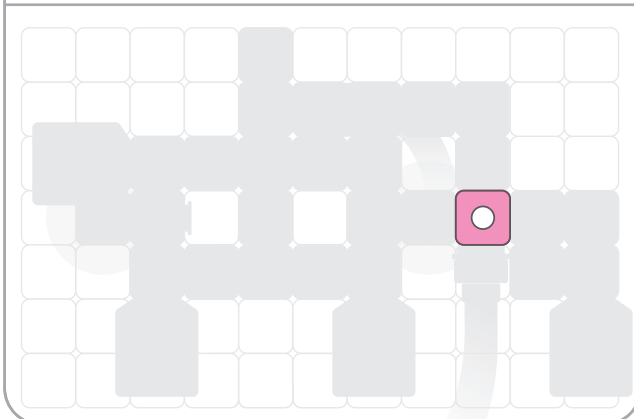

15



x1
turquoise
double-exit

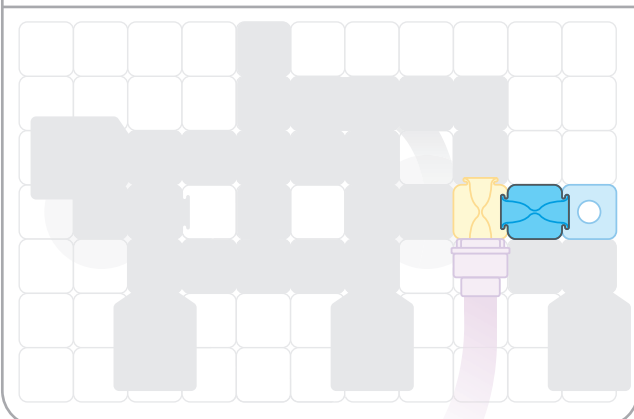

18



x1
magenta
single-exit

